

RAMPS PROVIDED FOR DIVYANGJAN STUDENTS:





PRES COPC NASHIK, Maharashtra, In...



Longitude Latitude

73.9398° E 19.8861° N



22° C

Wednesday, 27, Nov, 2019

10:02 AM

DISABLED-FRIENDLY WASHROOMS PHOTO:



SIGN-POST PHOTO:

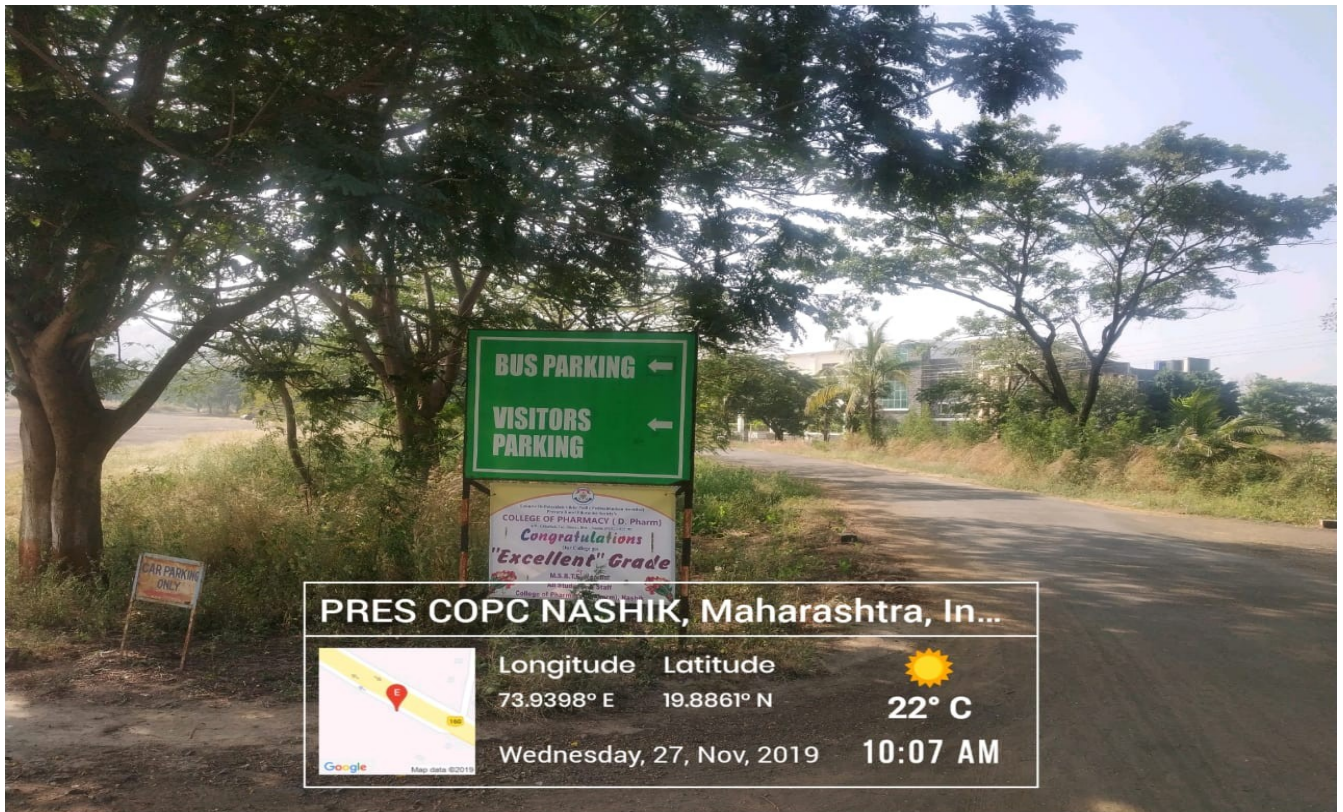

DISPLAY BOARD PHOTO:

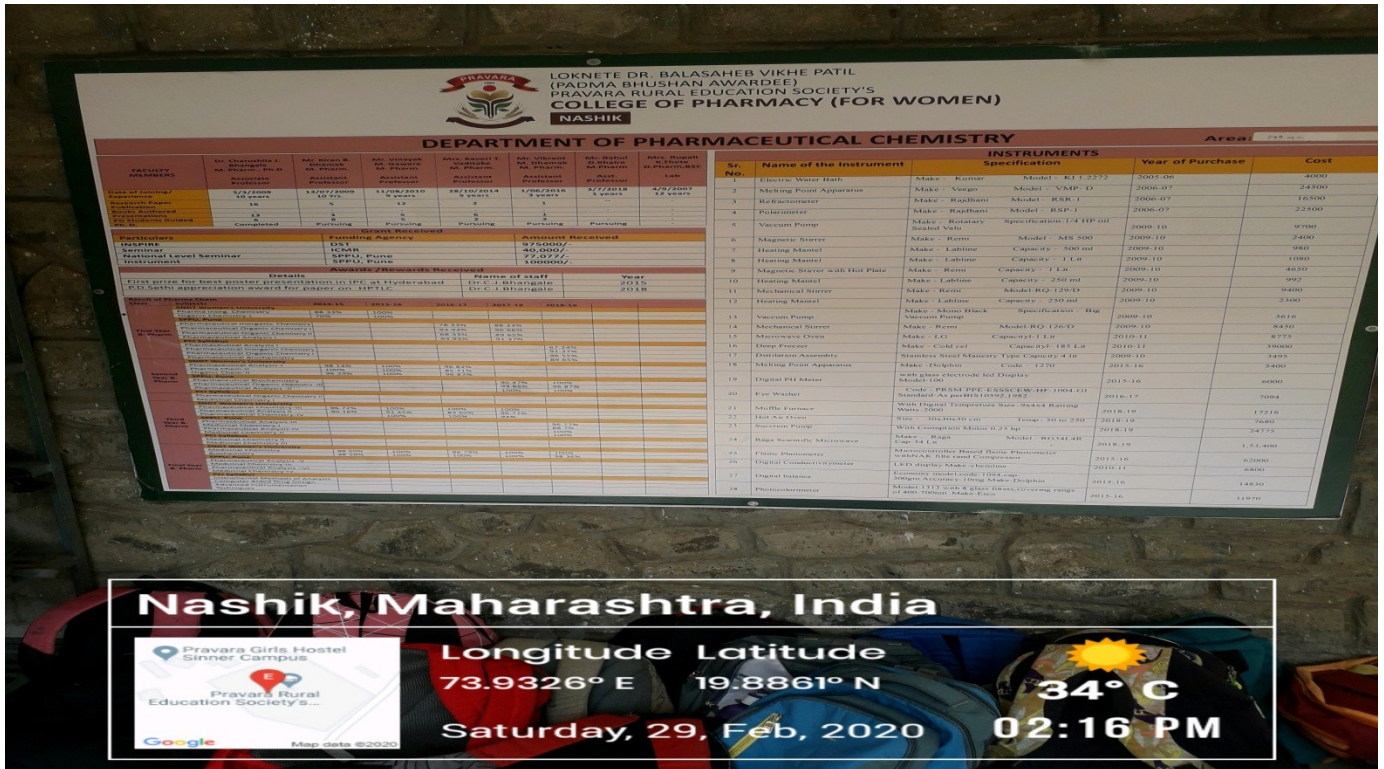

LOKNETE DR. BALASAMBH VIKHE PATIL
(PADMA BHUSHAN AWARDEE)
PRAVARA RURAL EDUCATION SOCIETY'S
COLLEGE OF PHARMACY (FOR WOMEN)
NASHIK

DEPARTMENT OF PHARMACEUTICS Area: 248 sq.m

FACULTY MEMBERS	Dr. Vivekanand A. Kashid	Dr. Ramdas T. Dolas	Dr. Sachin B. Somwanshi	Dr. Anagha V. Bavisar	Mr. Vikas D. Kande	Ms. Pallavi D. Paval
	M. Pharm., Ph.D. Assistant Professor	M. Pharm., Ph.D. Assistant Professor	M. Pharm., Ph.D. Assistant Professor	M. Pharm., Ph.D. Assistant Professor	M. Pharm., Ph.D. Assistant Professor	Lab Assistant
Date of joining/Experience	15/06/2007	18/09/2008	01/08/2009	18/11/2009	16/08/2014	24/07/2007
Research Paper Publication	08	11	19	05	01	—
Books Authored	05	07	12	05	02	—
Presentations	05	04	02	03	01	—
In-charge Students Guided Ph. D.	Completed	Completed	Completed	Completed	Pursuing	—

Particulars	Grant Received		Amount Received	
	Existing Agency	ICMR	SPPU, Pune	SPPU, Pune
Seminar	—	—	40,000/-	—
State Level Seminar	—	—	47,000/-	—
Instrument	—	—	1,00,000/-	—

Awards / Awards received			
Details	Name of staff	Year	
Best poster award (III position) at SPPU sponsored State Level Conference held at M.S.G.C.O.P.E.R., Nashik	Dr. S. B. Somwanshi	2017-18	
Certificate of Appreciation as Judge at Avishkar 2016 - A National Level Innovative Idea Competition for Budding Pharmacists	Dr. R. T. Dolas	2015-16	
Certificate of Appreciation as Judge at Avishkar 2016 - A National Level Innovative Idea Competition for Budding Pharmacists	Dr. V.A. Kashid	2015-16	
Best paper in Indian Society of Concept Management	Dr. S. B. Somwanshi	2014-15	

Dr. No.	Name of the instrument	Make	Year of purchase	Cost
1	Janet Faculty test apparatus	Make: ETB	2008-09	3921
2	Digital pH meter	Make: Chemline	2009-10	20,000
3	Bulk dosing apparatus	Make: Bio System	2006-10	21,000
4	Capsize filling machine	capacity 100 capsule complete 35 body (rota) code no. CEM100	2014-15	11,500
5	Electronic digital Balance 10mg sensitivity	Make: Delphina	2014-15	29,750
6	Electronic digital Balance 10mg sensitivity	Make: Delphina	2014-15	29,750
7	Hardness tester	Type: monosauto	2008-09	10,000
8	Hardness tester	Type: gfror	2010-12	6,000
9	Circulating water bath	WB2000/circulating bath temp range 10 to 1000	2009-10	7,000
10	Powder sifter	Make: Komet	2009-10	1,600
11	Hot oil oven	type 18" 18" 18" inner 55 analogue	2009-10	2,500
12	Ampoule washing device	Special Lab	2009-10	2,500
13	Ampoule clarity test apparatus	Special Lab	2009-10	1,400
14	Laminar air flow	bench top horizontal metal type with inner and outer powder coated mesh 30" diameter of design to provide project free distilled water assembly	2009-10	54,500
15	Water viz complete unit	make: 30" diameter of design to provide project free distilled water assembly	2010-11	9,000
16	Ampoule filling and sealing machine	Special Lab	2010-11	9,000

Year	Subject					
	2014-15	2015-16	2016-17	2017-18	2018-19	
First Year B. Pharm	Pharmaceutics I	98.33	100	—	—	
	Pharmaceutics II	85.00	100	—	—	
	Pharmaceutics I	—	—	80	76.66	—
	Pharmaceutics II	—	—	80.00	80.00	—
	Pharmaceutics I	—	—	100	83.33	—
Second Year B. Pharm	Pharmaceutics I	—	—	—	—	93.10
	Pharmaceutics II	—	—	—	—	—
	Pharmaceutics I	100	100	98.41	—	—
	Pharmaceutics II	100	100	96.82	—	—
	Pharmaceutics I	100	100	96.82	—	—
Third Year B. Pharm	Pharmaceutics I	100	100	98.41	—	—
	Pharmaceutics II	100	100	96.82	—	—
	Pharmaceutics I	100	100	98.41	—	—
	Pharmaceutics II	100	100	98.41	—	—
	Pharmaceutics I	100	100	98.41	—	—

Nashik, Maharashtra, India

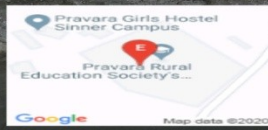

Longitude **73.9326° E** Latitude **19.8861° N**



34° C

Saturday, 29, Feb, 2020

02:16 PM

PERIODIC TABLE

**Safety is presence of mind
Accident are an absence of mind**

KEEP SILENCE **MOBILES PHONE IS RESTRICTED**

Nashik, Maharashtra, India

Longitude **73.9326° E** Latitude **19.8861° N**

34° C

Saturday, 29, Feb, 2020

02:16 PM



Nashik, Maharashtra, India



Longitude Latitude
73.9326° E 19.8861° N



34° C
02:16 PM

Saturday, 29, Feb, 2020

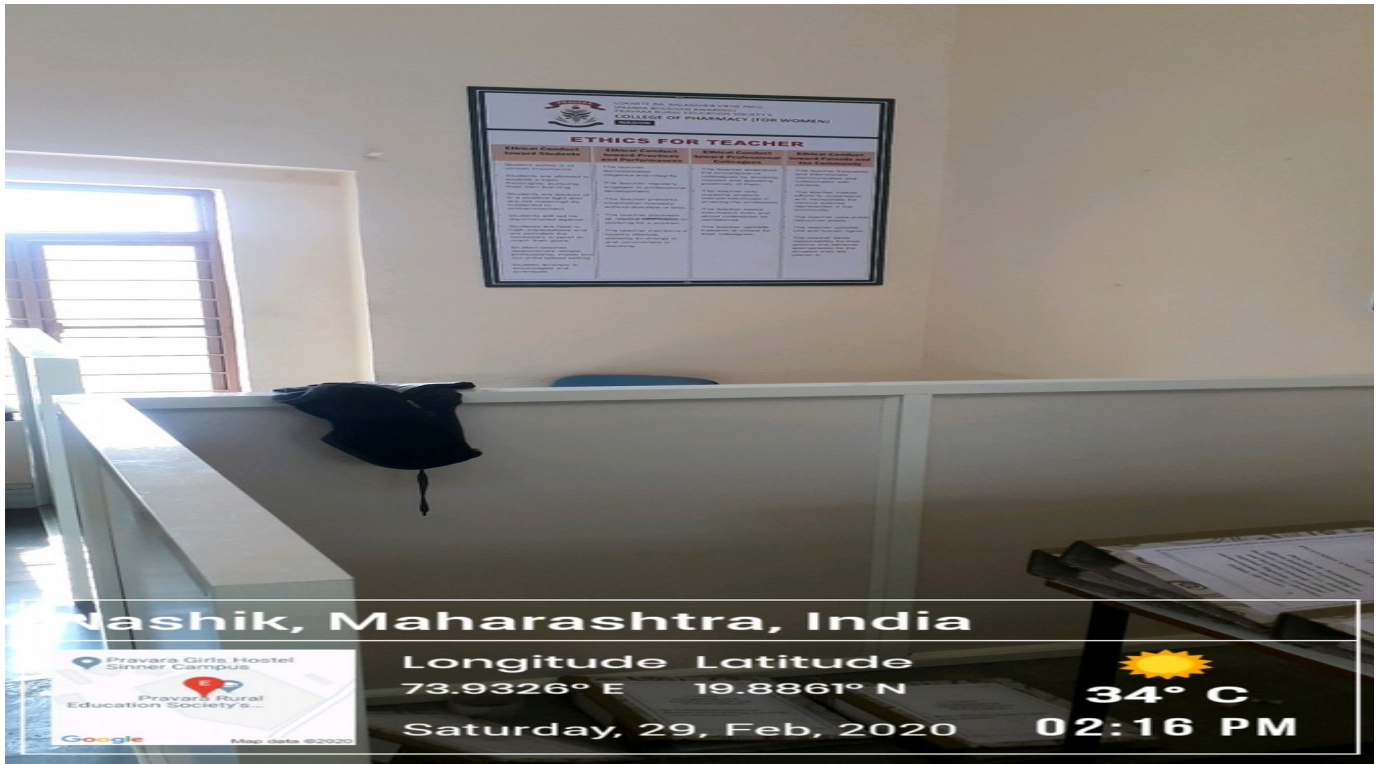

Nashik, Maharashtra, India

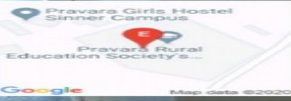

Longitude Latitude
73.9326° E 19.8861° N



34° C
02:16 PM

Saturday, 29, Feb, 2020

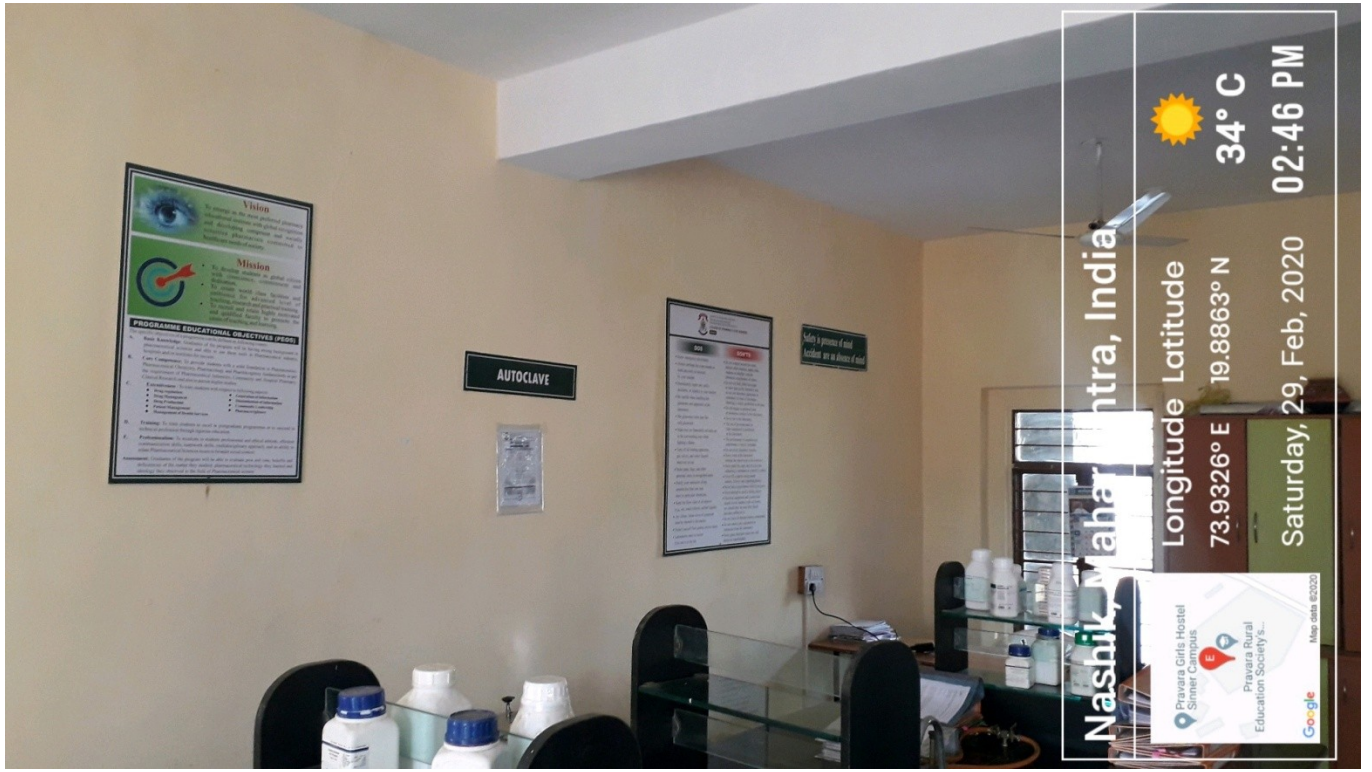

**Rate of accident is fast
When Safety comes last.**

 LOKNETE DR. BALASAHIB VIKHE PATIL
 (PADMA BHUSHAN AWARDEE)
 PRAVARA RURAL EDUCATION SOCIETY'S
COLLEGE OF PHARMACY (FOR WOMEN)
 NASHIK

MICROBIOLOGY LAB Area-75 Sq.m

Sr. No.	Name of Instrument	Specification	Year of Purchase	Cost
1	Refrigerator	Make - Godrej Capacity - 170 lit	2005-06	2307
2	Oven	Make - Kumar Model-KI-03-03	2005-06	12000
3	Incubator	Make - Kumar Model-KI-05-03	2005-06	22000
4	Colony Counter	Make - Chemline Micro-controller Based with 9999 count	2010-11	4500
5	Antibiotic Zone Reader	Make - Coslab Model-PL-09112010	2015-16	20,700
6	Digital PH Meter	Make - Dolphin Model-1082	2015-16	6,600
7	Monocular Microscope	Make - Labomed Model-STC1000 HL	2006-07	10800
8	Laboratory Microscope	with objective x5, x10, x45, x100	2005-06	4570
9	Autoclave	Inner Chamber made of 505 Capacity 35 lit	2009-10	56950

Nashik, Maharashtra, India



Longitude Latitude
73.9326° E 19.8863° N

34° C

GLASS
Saturday, 29, Feb, 2020

02:46 PM



 LOKNETE DR. BALASAHIB VIKHE PATIL
 (PADMA BHUSHAN AWARDEE)
 PRAVARA RURAL EDUCATION SOCIETY'S
COLLEGE OF PHARMACY (FOR WOMEN)
 NASHIK

INSTRUMENT ROOM Area-75 Sq.m

Sr. No.	Name of Instrument	Specification	Year of Purchase	Cost
1	UV- Spectrophotometer	Make - Shimadzu Model - A11454500	2008-09	405000
2	Dissolution test app.	Make - ELBT Model - TD108L	2008-09	195418
3	Tablet disintegration test app.	Make - ELBT Model - EC-2L	2008-09	61871
4	Friability test apparatus	Make - ELBT Model - EF-2	2008-09	39921
5	Digital Photofluorimeter	CL-950, Make - Chemline	2010-11	33500
6	UV Cabinet	Make - Dolphin Wave length - 254 nm to 365 nm	2014-15	14472
7	Water distillation assembly	Type - Manesty cap- 2lit/hr	2015-16	6315
8	Oven Humidity	Make - EIE INSTRUMENT Humi Range -35RH to 95RH	2015-16	108058
9	BOD incubator	Inner Chamber made of 505 micro Processor	2015-16	53,200
10	Photo colorimeter	Model-1313 with 8 glass filters covering range of 400-700nm Make-Esco	2015-16	11970
11	Nepheloturbidimeter	Model - LT-34	2018-19	8024

REMOVE SHOES HERE

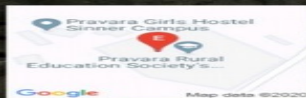
Nashik, Maharashtra, India



Longitude Latitude
73.9326° E 19.8863° N

34° C

Saturday, 29, Feb, 2020

02:46 PM

LOKNETE DR. BALASAHEB VIKHE PATIL
(PADMA BHUSHAN AWARDEE)
PRAVARA RURAL EDUCATION SOCIETY
COLLEGE OF PHARMACY (FOR WOMEN)
NASHIK-727001

OBC CELL

Name of Member	Nomination	Designation
Dr.C.J.Bhangale	Chairman	Principal
Dr. A.V.Baviskar	Co-ordinator	Staff representative
Ms.Gayatri Satpute	Member	Students representative
Ms.Vidya Khule	Member	Students representative
Ms. Tejal Sejul	Member	Students representative

Nashik, Maharashtra, India



Longitude Latitude
73.9326° E 19.8863° N



34° C

Saturday, 29, Feb, 2020

02:46 PM

LOKNETE DR. BALASAHEB VIKHE PATIL
(PADMA BHUSHAN AWARDEE)
PRAVARA RURAL EDUCATION SOCIETY'S
COLLEGE OF PHARMACY (FOR WOMEN)
NASHIK

RESEARCH AND DEVELOPMENT CELL

Sr.No	Name of Staff	Designation	Contact number
1	Dr.C.J.Bhangale	Chairman	9011140176
2	Dr.S.B.Somwanshi	Academic Research Co-ordinator	9975101498
3	Dr.K.B.Kotade	Member	9422935587
4	Dr.R.T.Dolas	Member	9657720340
5	Mr.K.B.Dhamak	Member	9623267010

Nashik, Maharashtra, India



34° C

Longitude Latitude

73.9326° E 19.8863° N

02:46 PM

Saturday, 29, Feb, 2020

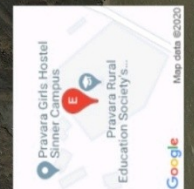



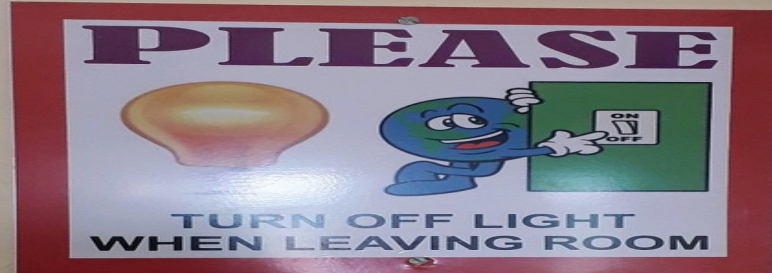

Nashik, Maharashtra, India



Longitude Latitude
73.9326° E 19.8863° N

Saturday, 29, Feb, 2020

34° C
02:46 PM

 LOKNETE DR. BALASAHEB VIKHE PATIL (PADMA BHUSHAN AWARDEE) PRAVARA RURAL EDUCATION SOCIETY'S COLLEGE OF PHARMACY (FOR WOMEN) NASHIK		
ALUMNI CELL		
Sr. No	Name of Staff	Designation
1	Mr. Vivekanand A. Kashid	President
2	Ms. Swati V. Vyavhare	Vice President
3	Ms. Sonali S. Sable	Secretary
4	Dr. Anagha V. Baviskar	Treasurer
5	Ms. Shweta J. Patil	Member
6	Ms. Amruta M. Vaykole	Member
7	Ms. Shubhangi S. Kothavade	Member
8	Ms. Jyoti P. Khapre	Member
9	Ms. Snehal B. Katore	Member
10	Ms. Smita R. Rupawate	Member

Nashik, Maharashtra, India

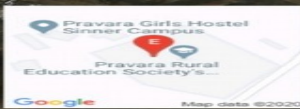

Longitude Latitude
73.9326° E 19.8863° N

Saturday, 29, Feb, 2020

34° C
02:46 PM

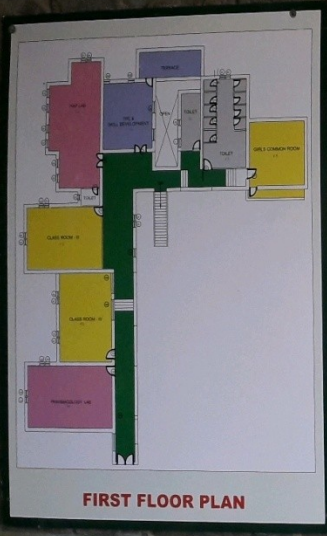

COLLEGE OF PHARMACY (FOR WOMEN)
 PRAVARA RURAL EDUCATION SOCIETY'S
 NASHIK

Sr. No.	Name of the Faculty	Name of Dept.	Responsibility
1. Training and Placement Cell			
1	Mrs.V.P.Aher	Pharmacy	Coordinator
2	Mr.V.D.Kunde	Pharmacy	Member
3	Mr.K.B.Dhamak	Pharmacy	Member
4	Mr.S.G.Laware	Pharmacy	Member
2. Entrepreneur Development Cell			
1	Mr.R.T.Dolas	Pharmacy	Coordinator
2	Ms.K.T.Vadliake	Pharmacy	Member
3	Ms.S.N.Bhandare	Pharmacy	Member
4	Mr.K.B.Kotade	Pharmacy	Member
3. Industry Institution Interaction Cell			
1	Mr.S.B.Somwanshi	Pharmacy	Coordinator
2	Mr.K.B.Kotade	Pharmacy	Member
3	Mr.V.M.Gaware	Pharmacy	Member
4	Mr.V.D.Kunde	Pharmacy	Member
4. Career Guidance Cell			
1	Mr.V.M.Dhamak	Pharmacy	Coordinator
2	Mr.S.B.Somwanshi	Pharmacy	Member
3	Dr.A.V.Baviskar	Pharmacy	Member
4	Mr.R.D.Khaire	Pharmacy	Member

Nashik, Maharashtra, India

34° C
 02:46 PM

Longitude Latitude
 73.9326° E 19.8863° N
 Saturday, 29, Feb, 2020

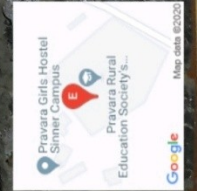

“विचार पुष्प”
 आपण इश्रपयंत आलो आहोत.
 इतरांनाही आपल्याला पुढे
 न्यावयाचे आहे.
 आपल्या नशिबाने आपल्याला
 चांगले दिवस आले आहेत.
 भावी पिढीलाही असेच चांगले
 दिवस येतील याची काळजी घ्या.
 पद्मश्री डॉ.विठ्ठलराव विखे पाटील

Nashik, Maharashtra, India

34° C
 02:46 PM

Longitude Latitude
 73.9326° E 19.8863° N
 Saturday, 29, Feb, 2020



**LOKNETE DR. BALASAHEB VIKHE PATIL
(PALEMA BHUSHAN AWARDEE)
PRAVARA RURAL EDUCATION SOCIETY'S
COLLEGE OF PHARMACY (FOR WOMEN)
NASHIK**

DEPARTMENT OF PHARMACOLOGY

FACULTY MEMBERS		Dr. Kiren B. Kotebade M. Pharm., Ph.D. Assistant Professor	Mrs. Sangita N. Bhandare M. Pharm. Assistant Professor	Mr. Mayur T. Gokhar M. Pharm. Assistant Professor	Mrs. Sangita A. Saravane BSC Lab Assistant
Date of Joining/ Experience	01/07/2008 11 years	08/07/2013 6 Yrs.	26/08/2017 2 years	02/08/2007 12 years	
Research Paper Publication	16	3	1		
Books Authored	-	-	-	-	
Presentations	4	2	-	-	
PG Students Guided	2	1	-	-	
Ph. D.	Completed	-	Pursuing	-	

Grant Received		Particulars		Funding Agency		Amount Received	
State Level Seminar		SPPU, Pune				40,749/-	

Sr. No.	Name of the Instrument	Specification	Year of Purchase	Cost
1	Isolated Organ Bath-10	Make - Orchid	2008-09	74800
2	Sherrington rotating drum-10	Make - Orchid	2008-09	86250
3	Eddy's Hot Plate	Make - Orchid	2008-09	11200
4	Rota Rod Apparatus	Make - Orchid	2008-09	19360
5	Air Conditioner	Make-Vohas, Tton	2009-10	21300
6	Electrovisuometer	Make - Orchid	2009-10	9000
7	Digital PH Meter	Make-Cherline	2009-10	3800
8	Centrifuge	Make-Remi	2009-10	3300
9	Actophotometer	Make - Orchid	2009-10	46000
10	Pole Climbing Apparatus	Make - Orchid	2009-10	24000
11	LCD Projector	Make-Sony VPLEx100	2011-12	39000
12	Isolated organ Bath-5	Make-Orchid, Model-SED Single Unit	2014-15	45000
13	Sherrington rotating drum-5	Make - Orchid, Model-SK01 CE	2014-15	47000
14	Digital balance	Make-Dolphin, cap-600gm, Accuracy-10mg	2015-16	25102
15	Digital balance	Make-Shimadzu, Cap-220gm, Readibility-0.001gm	2015-16	45964
16	Distillation Assembly	Make-Stechnich, Stainless Steel Mansy Type Capacity 5lit	2015-16	8367
17	Sphygmomanometer	Make-Omron, Automatic BP Monitor	2015-16	8128
18	Spirometer	Make-Orchid, Dial Type	2015-16	10710
19	Digital Plethysmometer	Make-Orchid, Model-PLM-02	2015-16	150131

Nashik, Maharashtra, India

34° C
 Longitude Latitude
 73.9326° E 19.8863° N
 Saturday, 29, Feb, 2020 02:46 PM

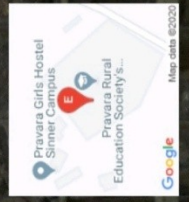

Nashik, Maharashtra, India

34° C
 Longitude Latitude
 73.9326° E 19.8863° N
 Saturday, 29, Feb, 2020 02:46 PM

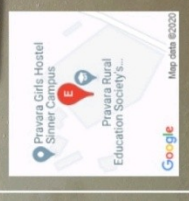



LOKNETE DR. BALASAHEB VIKHE PATIL
(PADMA BHUSHAN AWARDEE)
PRAVARA RURAL EDUCATION SOCIETY'S
COLLEGE OF PHARMACY (FOR WOMEN)
NASHIK

DISCIPLINE COMMITTEE

Sr. No.	Name	Designation	Mob. Number
1.	Dr.C.J.Bhangale	Chairman	9011140176
2.	Mrs.V.P.Aher	Member	9225190058
3.	Mrs.S.N.Bhandare	Member	9623981019
4.	Dr.R. T.Dolas	Member	8208873940
5.	Dr.S.B.Somwanshi	Member	9975101498

Nashik, Maharashtra, India

☀️ **34° C**

Longitude Latitude
73.9326° E 19.8863° N

Saturday, 29, Feb, 2020 02:46 PM





Prohibition of Ragging in Educational Institutions Act 26 of 1997

Salient Features :

- ☞ Ragging within or outside any educational institution is Prohibited.
- ☞ Ragging means doing an act which causes or is likely to cause insult or Annoyance of Fear or Apprehension or Threat or intimidation or outrage of modesty or Injury to a student.

Nashik, Maharashtra, India

☀️ **34° C**

Longitude Latitude
73.9326° E 19.8863° N

Saturday, 29, Feb, 2020 02:46 PM



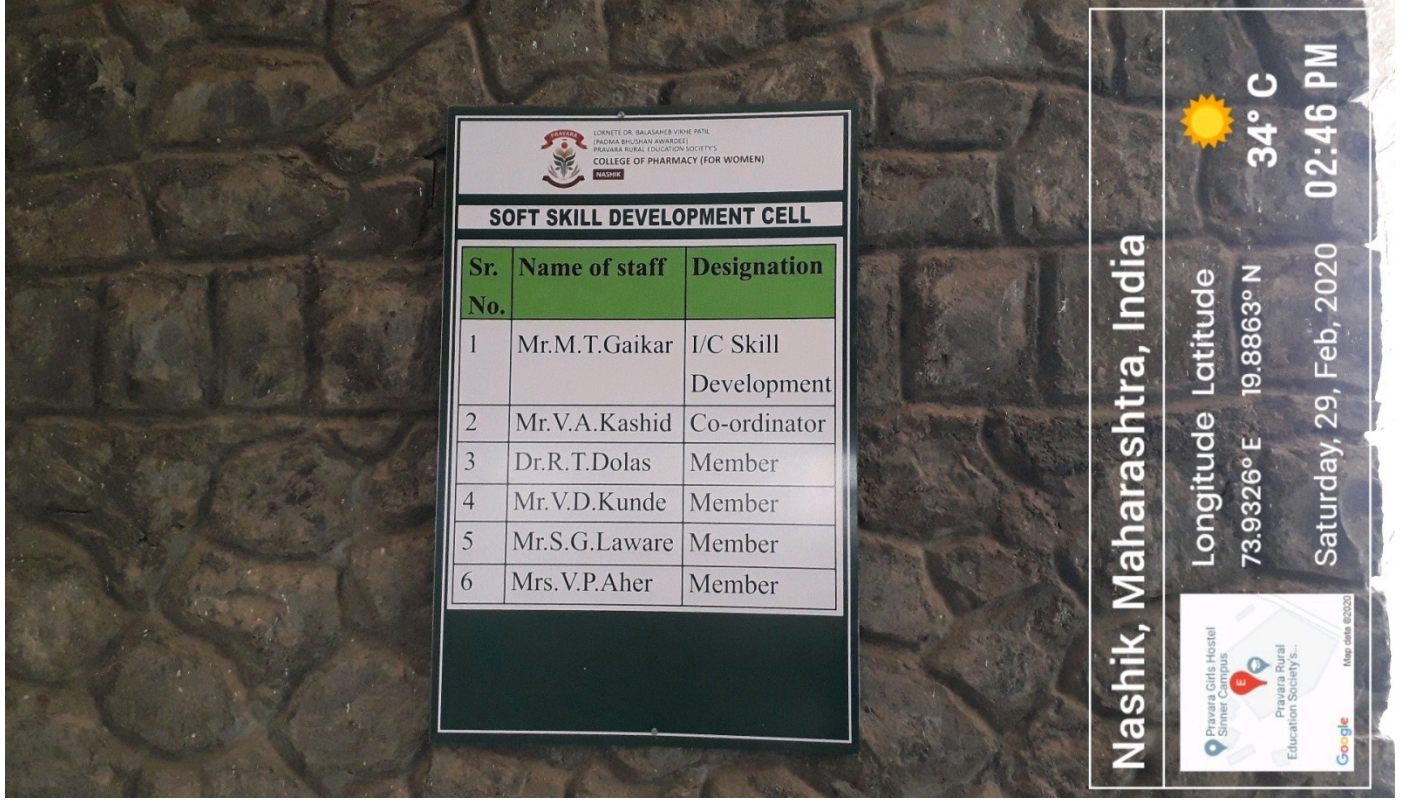



 LOKNETE DR. BALASAHEB VIKHE PATIL
 (PADMA BHUSHAN AWARDEE)
 PRAVARA RURAL EDUCATION SOCIETY'S
COLLEGE OF PHARMACY (FOR WOMEN)
 NASHIK

GRIEVANCE REDRESSAL CELL

Sr. No	Name of Faculty	Designation
1	Dr.C.J.Bhangale	Chairman
2	Mrs.V.P.Aher	Female faculty member
3	Dr.A.V.Baviskar	Female faculty member
4	Mrs.S.N.Bhandare	Female faculty member
5	Ms.K.T.Vaditake	Female faculty member
6	Ms.Nalini Chaudhari	(Students Representative)

Nashik, Maharashtra, India

Longitude Latitude
73.9326° E 19.8863° N

34° C

02:46 PM

Saturday, 29, Feb, 2020



Academic Achievement 2018-19
S.N.D.T. Women's University
Toppers of B. Pharmacy

 LOKNETE DR. BALASAHEB VIKHE PATIL
 (PADMA BHUSHAN AWARDEE)
 PRAVARA RURAL EDUCATION SOCIETY'S
COLLEGE OF PHARMACY (FOR WOMEN)
 NASHIK

Congratulations



Swapnali Sanjay Abhale
77.54%
First Topper



Nikita Sharad Sonawane
76.62%
Second Topper



Gitanjali Bhimraj Galande
75.31 %
Third Topper



Prajakta Sanjay Mahajan
74.00%
Fifth Topper

From : management principal & staff

Approved by AICTE, Pharmacy Council of India, New Delhi and recognized by Govt. of Maharashtra
 AISHE Code No. C-44115
 Address: At /Po. Chincholi, Tal-Sinhal, Dist. Nashik (MS) Pin-422 102
 Ph.No. : +91-2551-271278 | Website : www.pravara.in | Email : principal@pravara.ac.in

Nashik, Maharashtra, India

Longitude Latitude
73.9326° E 19.8863° N

34° C

02:46 PM

Saturday, 29, Feb, 2020



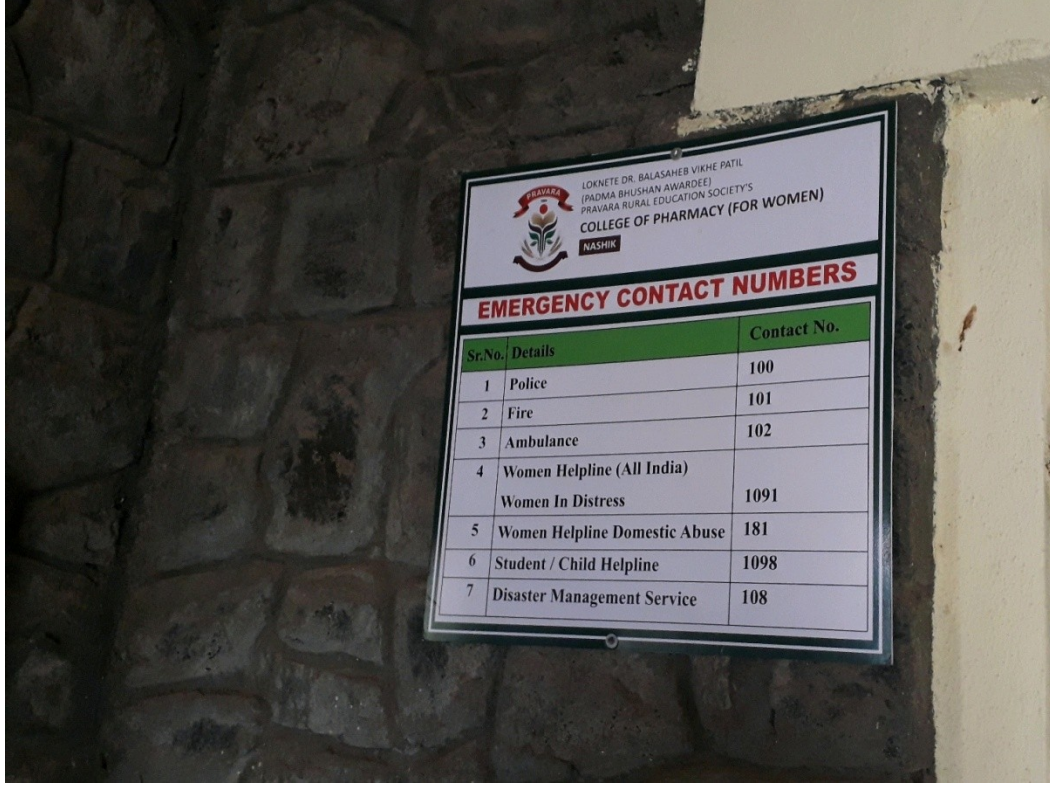

PRAVARA
LOKNETE DR. BALASAHEB VIKHE PATIL
(PADMA BHUSHAN AWARDEE)
PRAVARA RURAL EDUCATION SOCIETY'S
COLLEGE OF PHARMACY (FOR WOMEN)
NASHIK

EMERGENCY CONTACT NUMBERS

Sr.No.	Details	Contact No.
1	Police	100
2	Fire	101
3	Ambulance	102
4	Women Helpline (All India)	
	Women In Distress	1091
5	Women Helpline Domestic Abuse	181
6	Student / Child Helpline	1098
7	Disaster Management Service	108

Nashik, Maharashtra, India

Pravara Girls Hostel Sinner Campus
Pravara Rural Education Society's...

Longitude **73.9326° E**
Latitude **19.8863° N**

34° C
02:46 PM
Saturday, Feb 29, 2020



Nashik, Maharashtra, India

Pravara Girls Hostel Sinner Campus
Pravara Rural Education Society's...

Longitude **73.9326° E**
Latitude **19.8863° N**

34° C
02:46 PM
Saturday, Feb 29, 2020



Nashik, Maharashtra, India

Longitude Latitude

34° C

02:46 PM

Pravara Girls Hostel
Senior Campus

Pravara Rural
Education Society's...

Map data ©2020

Google



Nashik, Maharashtra, India

Longitude Latitude

34° C

02:46 PM

73.9326° E 19.8863° N

Pravara Girls Hostel
Senior Campus

Pravara Rural
Education Society's...

Map data ©2020

Google

LOKNETE DR. BALASAHEB VIKHE PATIL
(PADMA BHUSHAN AWARDEE)
PRAVARA RURAL EDUCATION SOCIETY
COLLEGE OF PHARMACY (FOR WOMEN)
NASHIK-422 101

MINORITY CELL

Name of Member	Nomination	Designation
Dr. C.J. Bhangale	Chairman	Principal
Dr. V.A. Kashid	Co-ordinator	Staff representative
Ms. Dehraj Annie	Member	Students representative
Ms. Ayesha Bootwala	Member	Students representative
Ms. Fiza Inamdar	Member	Students representative

LOKNETE DR. BALASAHEB VIKHE PATIL
(PADMA BHUSHAN AWARDEE)
PRAVARA RURAL EDUCATION SOCIETY'S
COLLEGE OF PHARMACY (FOR WOMEN)
NASHIK

ANTI DISCRIMINATION CELL

Sr.No	Name of staff	Designation	Contact Number
1	Dr. C.J. Bhangale	Chairman	9011140176
2	Dr. R.T. Dolas	Member	8208873940
3	Mrs. V.P. Aher	Member	9225190058
4	Mr. V.M. Gaware	Member	9423572791
5	Mrs. L.D. Ahire	Member	8390830742
6	Mr. S.B. Magar	Member	9657250353

Nashik, Maharashtra, India

☀️ **34° C**

Longitude Latitude
73.9326° E 19.8863° N

Saturday, 29, Feb, 2020 **02:46 PM**

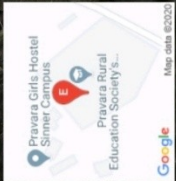

LOKNETE DR. BALASAHEB VIKHE PATIL
(PADMA BHUSHAN AWARDEE)
PRAVARA RURAL EDUCATION SOCIETY'S
COLLEGE OF PHARMACY (FOR WOMEN)
NASHIK

EXAMINATION CELL

Sr. No	Name of Staff	Designation	Contact Number	Email ID
1	Dr. C.J. Bhangale	Chairman	9011140176	charushila.bhangale@pravara.in
2	Dr. S.B. Somwanshi	CEO	9975101498	sachinsomwanshi27@gmail.com
3	Dr. K.B. Kotade	Internal Exam Co-ordinator	9422935587	kirankotade@gmail.com
4	Mrs. L.D. Ahire	Asst. Exam section	8390830742	latagaware@gmail.com

Nashik, Maharashtra, India

☀️ **34° C**

Longitude Latitude
73.9326° E 19.8863° N

Saturday, 29, Feb, 2020 **02:46 PM**

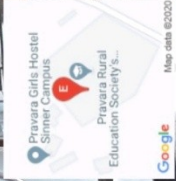



Nashik, Maharashtra, India

Longitude Latitude
73.9326° E 19.8863° N

34° C
02:46 PM

Saturday, 29, Feb, 2020

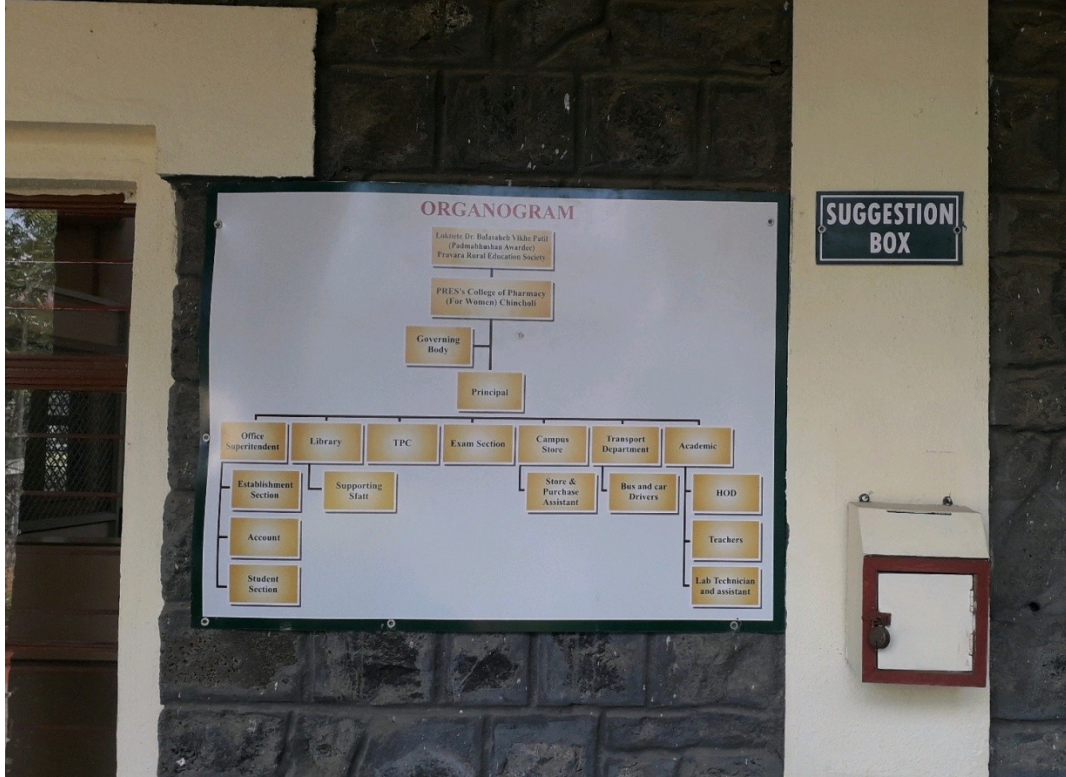

Nashik, Maharashtra, India

Longitude Latitude
73.9333° E 19.8828° N

34° C
02:55 PM

Saturday, 29, Feb, 2020

WHEEL CHAIR PHOTO:





Nashik, Maharashtra, India

☀️ **30° C**

Longitude Latitude
73.9388° E 19.886° N

Friday, 13, Mar, 2020 05:13 PM



Nashik, Maharashtra, India

☀️ **30° C**

Longitude Latitude
73.9388° E 19.886° N

Friday, 13, Mar, 2020 05:13 PM

MAGNIFYING LENS PHOTO:

